

a letter from the senior minister

REV. DR. JOHN C. BREARLEY

ON YOUR MARK, GET SET...

The **Build The Future** campaign is about to launch! *By May 1, the materials will arrive in your regular mail and in your email. Please take a few quality minutes to read and respond.* We are hoping that the campaign will be complete by May 15, but you may return your pledge at any time. All gifts are greatly appreciated! Of course, all responses are intended to be above and beyond our regular annual giving.

This week the spotlight turns toward our much-needed Youth Center. Three million dollars of this campaign are designated for the younger members of our church. Our youth (middle and high school) are active in their faith and growing in their participation. This new space will allow them to expand even further, and will provide opportunities for them to connect with church in a variety of ways. Conveniently located behind the Growing Tree, our exceptional pre-school and kindergarten program, this building will also be used by our youngest children during the weekday mornings. Now fully established and totally self-sufficient financially, the Growing Tree will benefit by two additional classrooms and daily recreation space.

The most frequently asked question about **Build The Future** is a financial one—*“what kind of gifts are people making?”* The simple answer is that everyone is trying to respond faithfully, sharing the God-given gifts we have received. Being generous is a true mark of daily discipleship. *While some people will work this three-year pledge into their monthly or annual budget, many are choosing to give accumulated assets—from savings, depreciated stocks, IRA distributions, real estate sales, business profits, and the like. All of these options greatly benefit the campaign, and offer potential large tax savings, as well.*

If have questions or thoughts about your gift, feel free to let me know. The campaign committee will gladly join you in this conversation!

Peace,

John

FIRST FLOOR

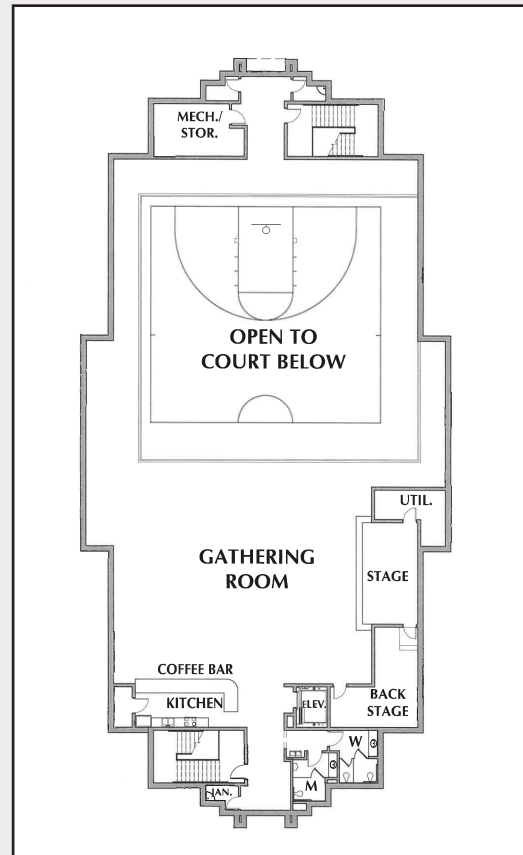
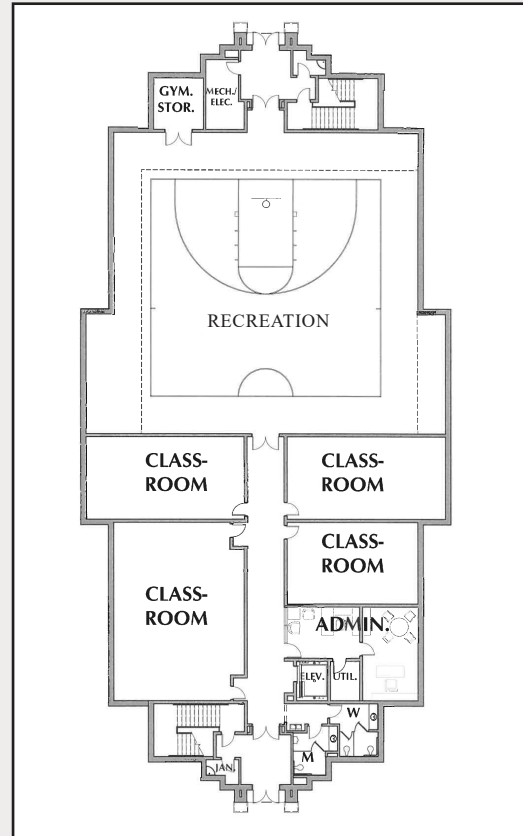

SECOND FLOOR

These are working plans and may change before final approval.